

## INSTRUMENTATION PRODUCT RANGE

### NEEDLE VALVES “NV” Series.

- 1/8” through to 2”
- 0 to 10,000 psi / 690 bar
- 5mm & 10mm Orifice options
- FxF, MxF, MxM NPT or BSP Process connections available
- Compression & OD Tube end connections available
- T bar or Anti Tamper handles
- PTFE or Graphite gland packing option
- Non-rotating tip provides bubble tight shut off
- Hexagonal bodied versions available



### NEEDLE VENT VALVES “NV” Series.

- 1/8” through to 1/2”
- 0 to 10,000 psi / 690 bar
- 5mm & 10mm orifice option
- FxF, MxF & MxM NPT or BSP Process connections available
- Compression & OD Tube end connections available
- T bar or Anti Tamper handles
- PTFE or Graphite gland packing option
- Non-rotating tip provides bubble tight shut off
- Complete with Bleed Plug

### MULTI PORT GAUGE VALVES “MPGV” Series.

- 1/8” through to 2”
- 0 to 10,000 psi / 690 bar
- 5mm & 10mm orifice options
- FxF, MxF & MxM NPT or BSP Process connections available
- T bar or Anti Tamper handles
- PTFE or Graphite gland packing option
- Non-rotating tip provides bubble tight shut off
- Bleed Plugs available



# **SIGMAHLR**

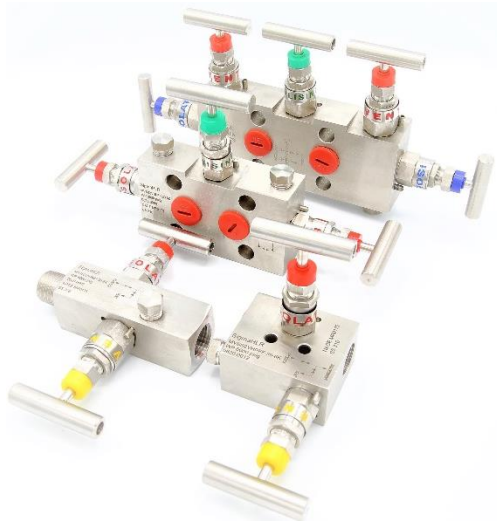

## **MANIFOLD VALVES “MV” Series.**

- 1/8” through to 1/2”
- 0 to 10,000 psi / 690 bar
- 5mm & 10mm orifice option
- NPT or BSP Process connections available
- 2, 3 & 5 Way types available
- Distribution Header manifolds available
- T Bar or Anti Tamper handles

### **NV, MPGV & MV SERIES FEATURES**

- *Bonnet lock pins prevent accidental loosening.*
- *Hardened ball seat specifically designed to be suitable for gas & fluid applications.*
- *Fully adjustable stem packing is located below the stem threads for extend packing life, superior sealing and ease of maintenance.*
- *Male, Female or any combination or process port connections available.*
- *Complying to ‘NACE MR-01-75’ latest specification as standard*

## **BALL VALVES “BV” Series.**

- 1/8” through to 2”
- 0 to 10’000 psi / 690 bar
- Reduced bore & Full bore plus Locking Device options
- Totally enclosed soft seating for low torque & positive sealing
- FxF, MxF, MxM NPR or BSP Process connections available
- Compression & OD Tube end connections available
- Complying to ‘NACE MR-01-75’ latest specification as standard



## **CHECK VALVES “CV” Series.**

- 1/8” through to 2”
- 0 to 10,000 psi / 690 bar
- FxF, MxF, MxM NPT & BSP Process connections available
- Compression & OD Tube end connections available
- Choice of cracking pressures
- Spring load poppet design
- Complying to ‘NACE MR-01-75’ latest specification as standard



# **SIGMA HLR**

## **THERMAL RELIEF VALVES “TRV” Series.**

- 1/8” through to 1/2” process connections
- 0 to 6,000 psi / 414 bar
- FxF, MxF, FxM NPT & BSP Process connections available
- Compression & OD Tube end connections available
- Manual Over-Ride / Lock Down Button available
- Suitable for Liquid or Gas applications
- Lock wire hole provided for anti-tamper provisions
- Complying to ‘NACE MR-01-75’ latest specification as standard



## **FLOW CONTROL VALVES “FCV” Series.**

- 1/8” through to 1”
- Uni-Directional & Bi-Direction Types
- 0 to 6’000 psi / 414 bar, Low & High Pressure Versions
- FxF, MxF, MxM NPT & BSP Process connections available
- Compression & OD Tube end connections available
- Non-Shut Off design to prevent ‘System Lock In’
- Standard, Fine & Extra Fine Meeting tips available
- Complying to ‘NACE MR-01-75’ latest specification as standard

## **CYLINDER PLUG VALVES “CPV” Series.**

- 1/8” through to 1” process connections
- 0 to 6,000 psi / 414 bar, Low & High Pressure Versions
- FxF, MxF NPT & BSP Process connections available
- Non-Shut Off design to prevent ‘System Lock In’
- Complying to ‘NACE MR-01-75’ latest specification as standard



- ✓ *All products in Stainless Steel 316L from stock or on short lead times*
- ✓ *Each valve individually tested & serial numbered for complete peace of mind and total traceability*
- ✓ *Female x Female, Male x Female, Male x Male or any combination of process port connections available*
- ✓ *Choice of thread forms offered*
- ✓ *Socket Weld, Butt Weld and Flanged versions to order*
- ✓ *Derivative, Hybrids and Specials available to order*
- ✓ *Exotics available in Duplex, Super Duplex, 6Mo, Hastelloy & Inconel*

# SIGMA HLR

SigmaHLR's new ISO 9001:2015 manufacturing facility is designed with quality and efficiency in mind by receiving raw materials in and finished goods out in a 'Clean' 'Lean' 'Productive' and 'Safety' environment. Pride, attention to detail and years of experience is ingrained in every product, whether it be a simple on/off instrument valve or a complex and fully assembled Hi / Low flow line pilot manifold assembly.



*At SigmaHLR every valve is function and pressure tested prior to leaving our factory to ensure superior in-service product performance, minimal maintenance and longevity of service.*



Constant and ongoing value engineering, review of manufacturing processes and employment of the latest technologies enable SigmaHLR to continue to be a world leader in the Manufacturing and supply of control and instrumentation valves throughout the global Oil & Gas industry.

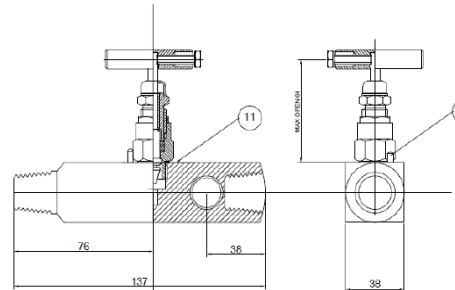

BILL OF MATERIALS TABLE			
NO	DESCRIPTION	MATERIAL	QTY
1	LOCK PIN	304SS	1
2	HANDLE	304SS	1
3	SPINDLE	A479 316L	1
4	DUST CAP	PVC	1
5	GLAND RETAINER	SS 316	1
6	LOCK NUT	SS 304	1
7	GLAND PACKING	PTFE	2
8	BONNET	A479 316L	1
9	BONNET WASHER	A479 316L	1
10	TRIM	A479 316L	1
11	BODY	A182F 316L	1

MATERIAL: ASTM 182 F 316L  
 TEST PRESSURE: @25°C Room temperature  
 Hydrostatic - Body & Seal - 1000 psi  
 Nitrogen Test - Pneumatic - Body & Seal - 50kg/cm<sup>2</sup>

**SigmaHLR is an ISO 9001:2015 Registered company**

**Quality System Registration**

**BRITISH ENGINEERING SERVICES**

This is to certify that:

Sturrock & Robson USA services Inc.  
 Dba Sturrock and Robson Manufacturing  
 Dba Shand Industries Inc.  
 Dba SIGMAHLR  
 1420 Lakeside Parkway, Suite 109  
 Flower Mound  
 TX - 75028  
 USA

Has been granted Registration Certificate No: BES/CAT00521038/1

In respect of a Quality Management System which has been assessed and found to comply with the requirements of ISO 9001:2015 for the following:

SCOPE:

- Design and manufacture of stainless steel valves and accessories including pneumatic and hydraulic valves, fusible valves and plugs, regulators, flowline connecting fittings for reinforced thermoplastic pipe and other products associated with control system fabrication.

For British Engineering Services:

*LL Sanders*

---

First registered: 07 Jan 2015    Valid from: 04 Jan 2020    Expiry: 03 Jan 2023

Issued by:  
 British Engineering Services  
 2 New York Street, Southampton, SO1 4GB

**BRITISH ENGINEERING SERVICES**

This certificate remains the property of British Engineering Services and is bound by the terms of the Certification agreement.

*SigmaHLR's product range is varied, extensive and continues to expand with both synergy and complimentary products adding both value and saving money for our customers.*

*Additional product bulletins are available, please contact your local SigmaHLR office for further details or visit our website.*

**SIGMA HLR**

**PRESSURE SENSORS**  
HLR 7970 SERIES

- Fully adjustable 10 to 10,000 PSI
- One Spring
- Four Piston Arrangements included with each and every sensor
- The most versatile stick pilot on the market

**SAND PROBES QUICK EXHAUST**

- Pneumatic or Electric
- For 2", 3", 4" and 6" Pipe
- 1/2" NPT Connection up to 10,000 PSI Working Pressure
- 1" MP Autoclave Connection up to 15,000 PSI Working Pressure

**HI-LO CONTROLLER UNITS (PSHL)**

- Adjustment Ranges:
  - 10-10,000 PSI (NPT)
  - 2,000 to 20,000 PSI (Autoclave style)

**HYDRAULIC REGULATOR**

- Adjustable
- Inlet Pressures to 10,000 psi
- Normally Opened or Normally Closed
- Pressures to 15,000 psi
- Sizes from 1/4" to 3/8" High Flow

**HYDRAULIC INTERFACE VALVES**

- Pilot Operated - Pneumatic and Hydraulic
- 2-way and 3-way
- Normally Opened or Normally Closed
- Pressures to 15,000 psi
- Sizes from 1/4" to 3/8" High Flow

(972)355-3047 • sales@sigmahlr.com

**Note.** The system designer, packager, installer and / or end user has the ultimate responsibility for correctly selecting products which are suitable for both their individual applications and project requirements thus ensuring safe and trouble-free installation, in service operation and maintenance / outages. Improper selection, installation and / or use of any products may lead to personal injury thus it is imperative that for each application the valves material of construction, pressure rating and process connections are considered and correctly selected.